

- GENERAL NOTES**
- DOORS TO BE 3'-0" x 6'-8" SOLID CORE WOOD WITH PAINT GRADE BIRCH VENEER.
  - WINDOWS TO BE ANDERSON VINYL CLAD CASEMENTS.
  - GYPSUM BOARD TO RECEIVE ONE COAT ALKYL PRIMER AND ONE COAT ALKYL BASE LOW GLOSS ENAMEL.
  - PROVIDE AND INSTALL ELECTRIC HEATERS SUFFICIENT TO MAINTAIN 55° F INSIDE WHEN CRITICAL TEMPERATURE IS 0°-F.
  - ROOF TRUSSES TO BE 24" O.C. WITH 12" OVERHANG. DESIGN LOADING AS PER N.Y. STATE CODE BUT NOT LESS THAN:  
32# HVE LOAD  
7# DEAD LOAD  
15# CEILING LOAD
  - PROVIDE STRUCTURAL ENGINEER'S SEAL ON DESIGN DRAWINGS

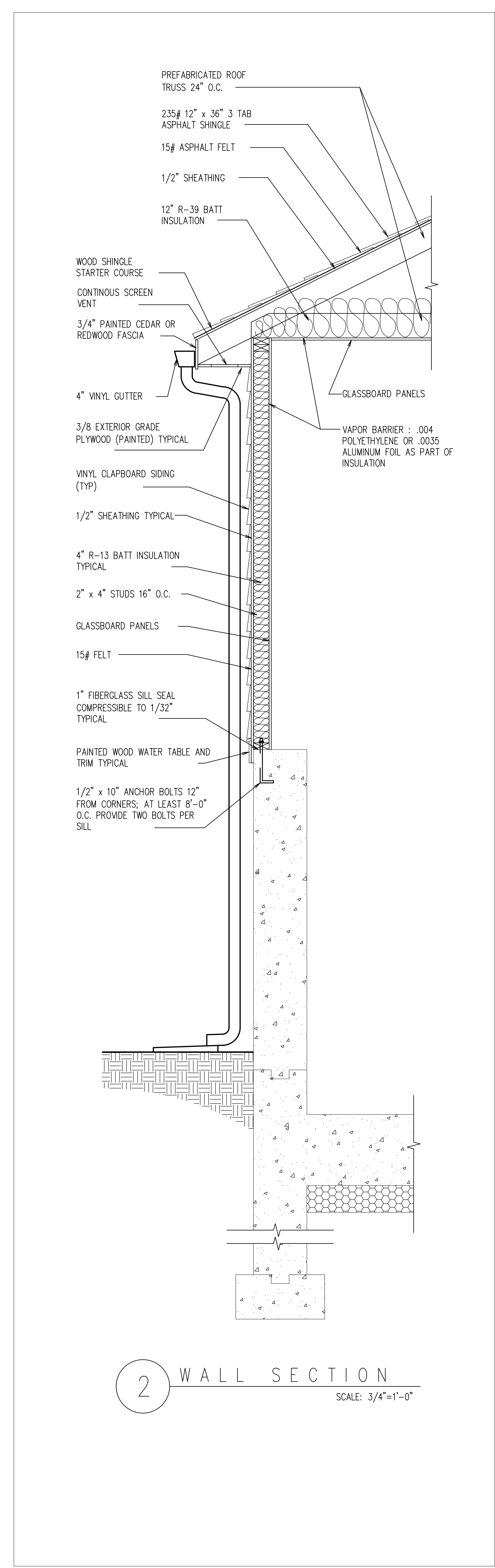
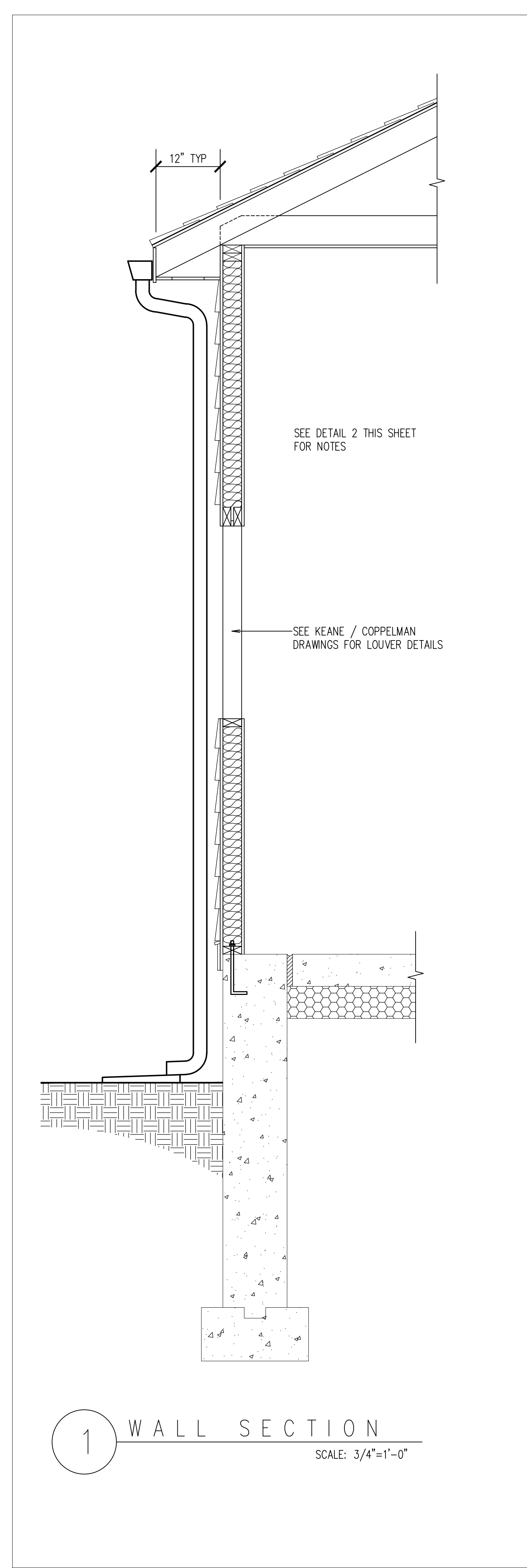

UNAUTHORIZED ALTERATIONS OR ADDITIONS TO THIS DRAWING IS A VIOLATION OF SECTION 7209, SUB-DIVISION 2, OF THE NEW YORK STATE EDUCATION LAW.

<b>OWNER / APPLICANT</b> JoFlo Of North Salem Box 20720 Cherokee Station New York, NY 10021-0074 Tel: (212) 988-8253 Email: JoFlo.north.salem@gmail.com	<b>PLANNING &amp; LANDSCAPE DESIGN</b> TIM MILLER ASSOCIATES, INC. 10 North Street Cold Spring, NY 10516 Tel: (845) 265-4400 www.timillerassociates.com	<b>PROJECT SURVEYOR</b> BUNNEY ASSOCIATES Professional Land Surveyor 301 Fields Lane Brewster, NY 10509 Tel: (845) 277-3404 e-mail: bunney.associates@verizon.net	<b>PROJECT ENGINEER</b> KEANE COPPELMAN GREGORY ENGINEERS, P.C. 113 Smith Avenue Mount Kisco, NY 10549 Tel: 914.241.2235 e-mail: INFO@KCGENGINEERS.COM
---	--	---	---

REV	DESCRIPTION	BY	DATE
1	TOWN PLANNER MEMO (7/8/2010) & TOWN ENGINEER MEMO (7/9/2010)	PL	December 29, 2010
2	TOWN PLANNER MEMO (9/9/2011) & TOWN ENGINEER MEMO (9/3/2011)	DPG	February 24, 2012
3	COMPLETENESS SUBMISSION	DPG	July 31, 2012
4	ACCEPTED DRAWING SET	DPG	September 12, 2012
5	RESOLUTION 139-13	PJG	April 22, 2013

ARCHITECTURAL ELEVATIONS WASTEWATER TREATMENT FACILITY HIGHGATE - WOODLANDS AT NORTH SALEM REED ROAD AND HARDSCRABBLE ROAD TOWN OF NORTH SALEM COUNTY OF WESTCHESTER STATE OF NEW YORK	DRAWN BY: RN SCALE: AS NOTED DATE: NOVEMBER 1, 2006 JOB NUMBER SHEET AE-1, WWTP 3 OF 15	CHECKED BY: DC
--	---	----------------

P.E. for Civil Engineering Only