

MATCHLINE TO SP-42
MATCHLINE TO SP-41

MATCHLINE TO SP-42
MATCHLINE TO SP-41

MATCHLINE TO SP-42
MATCHLINE TO SP-41

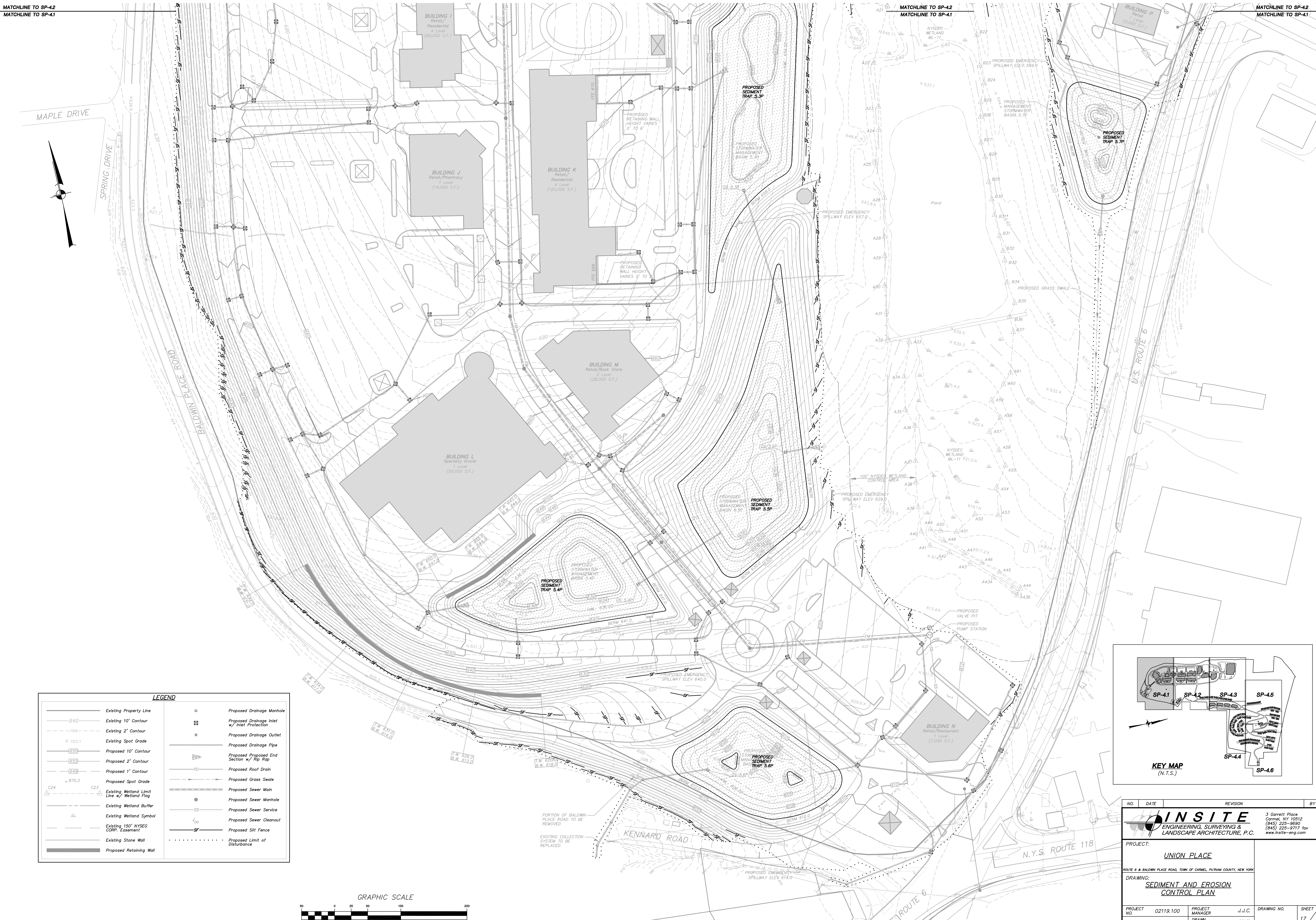
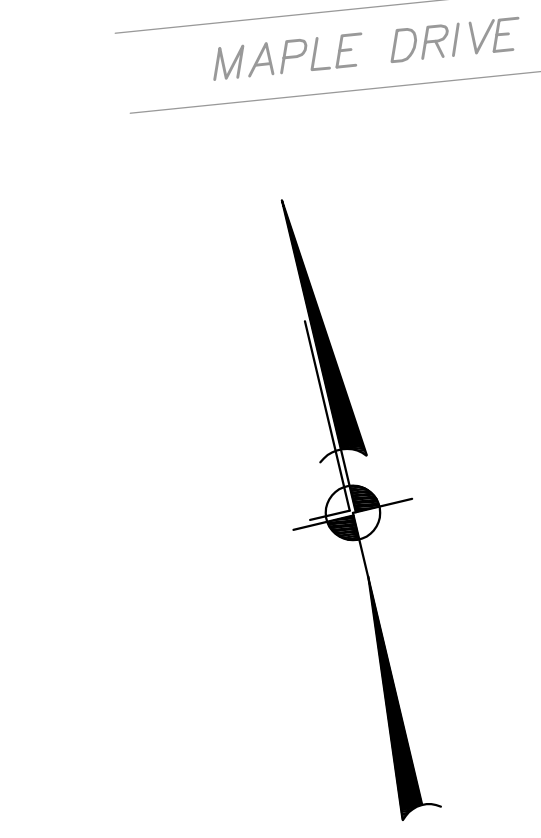

LEGEND			
—	Existing Property Line	○	Proposed Drainage Manhole
— 84.0 —	Existing 10' Contour	□	Proposed Drainage Inlet w/ Inlet Protection
— 70.4 —	Existing 2' Contour	■	Proposed Drainage Outlet
X 703.1	Existing Spot Grade	—	Proposed Drainage Pipe
— 65.0 —	Proposed 10' Contour	—	Proposed Drainage End Section w/ Rip Rap
— 65.2 —	Proposed 2' Contour	—	Proposed Roof Drain
— 64.9 —	Proposed 1' Contour	—	Proposed Grass Swale
+ 870.2	Proposed Spot Grade	—	Proposed Sewer Main
△ C24	Existing Wetland Limit Line w/ Wetland Flag	●	Proposed Sewer Manhole
—	Existing Wetland Buffer	○	Proposed Sewer Service
—	Existing Wetland Symbol	SS	Proposed Sewer Cleanout
—	Existing 150' NYSED CORP. Easement	—	Proposed Silt Fence
—	Existing Stone Wall	—	Proposed Limit of Disturbance
—	Proposed Retaining Wall		

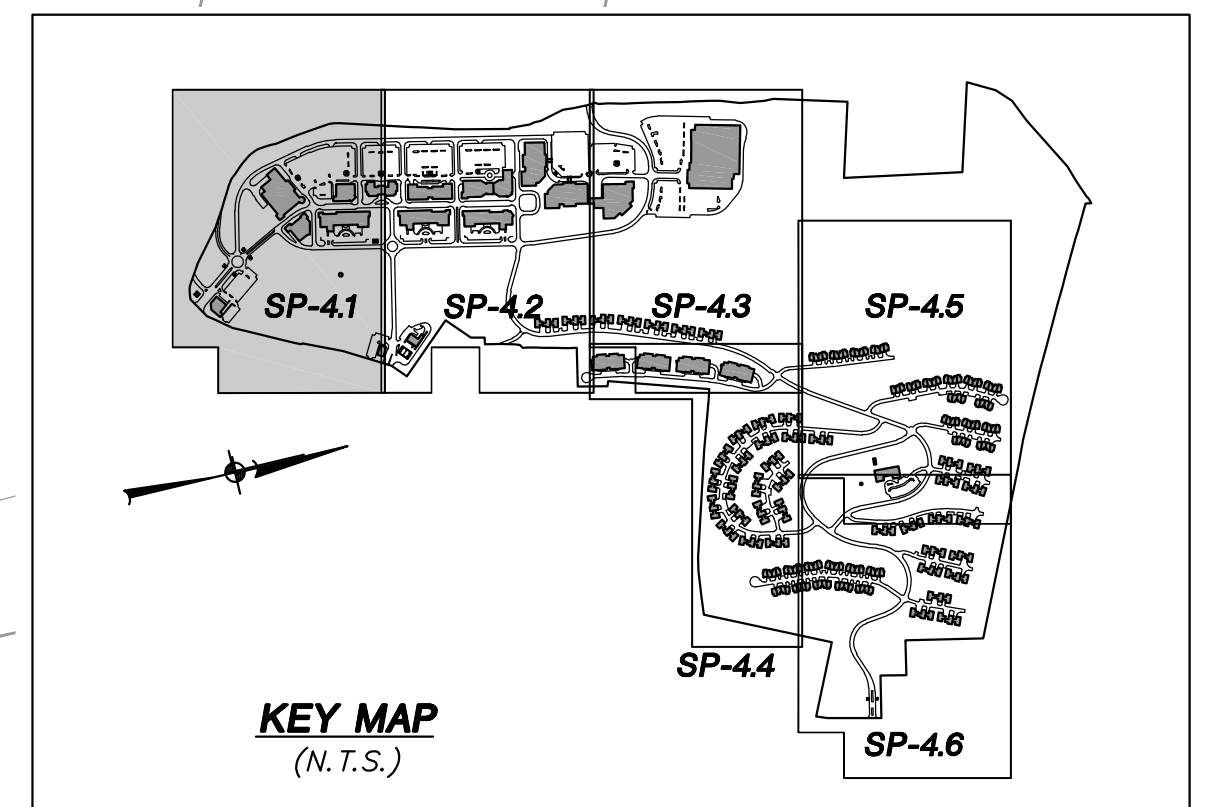
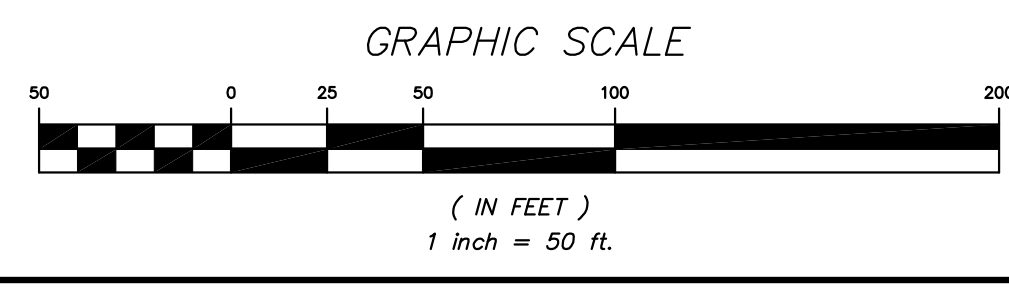

NO.	DATE	REVISION	BY
PROJECT: UNION PLACE ROUTE 6 & BALDWIN PLACE ROAD, TOWN OF CARMEL, PUTNAM COUNTY, NEW YORK			
DRAWING: SEDIMENT AND EROSION CONTROL PLAN			
PROJECT NO.	02119.100	PROJECT MANAGER	J.J.C.
DATE	2-20-09	DRAWN BY	J.L.K.
SCALE	1" = 50'	CHECKED BY	R.D.W.
DRAWING NO.		SHEET	17
			32

ALTERATION OF THIS DOCUMENT, UNLESS UNDER THE DIRECTION OF A LICENSED PROFESSIONAL ENGINEER, IS A VIOLATION OF SECTION 2209 OF ARTICLE 145 OF THE EDUCATION LAW.