

UNION HEIGHTS WEST ROAD
SCALE: HORIZ. 1" = 100'
VERT. 1" = 20'

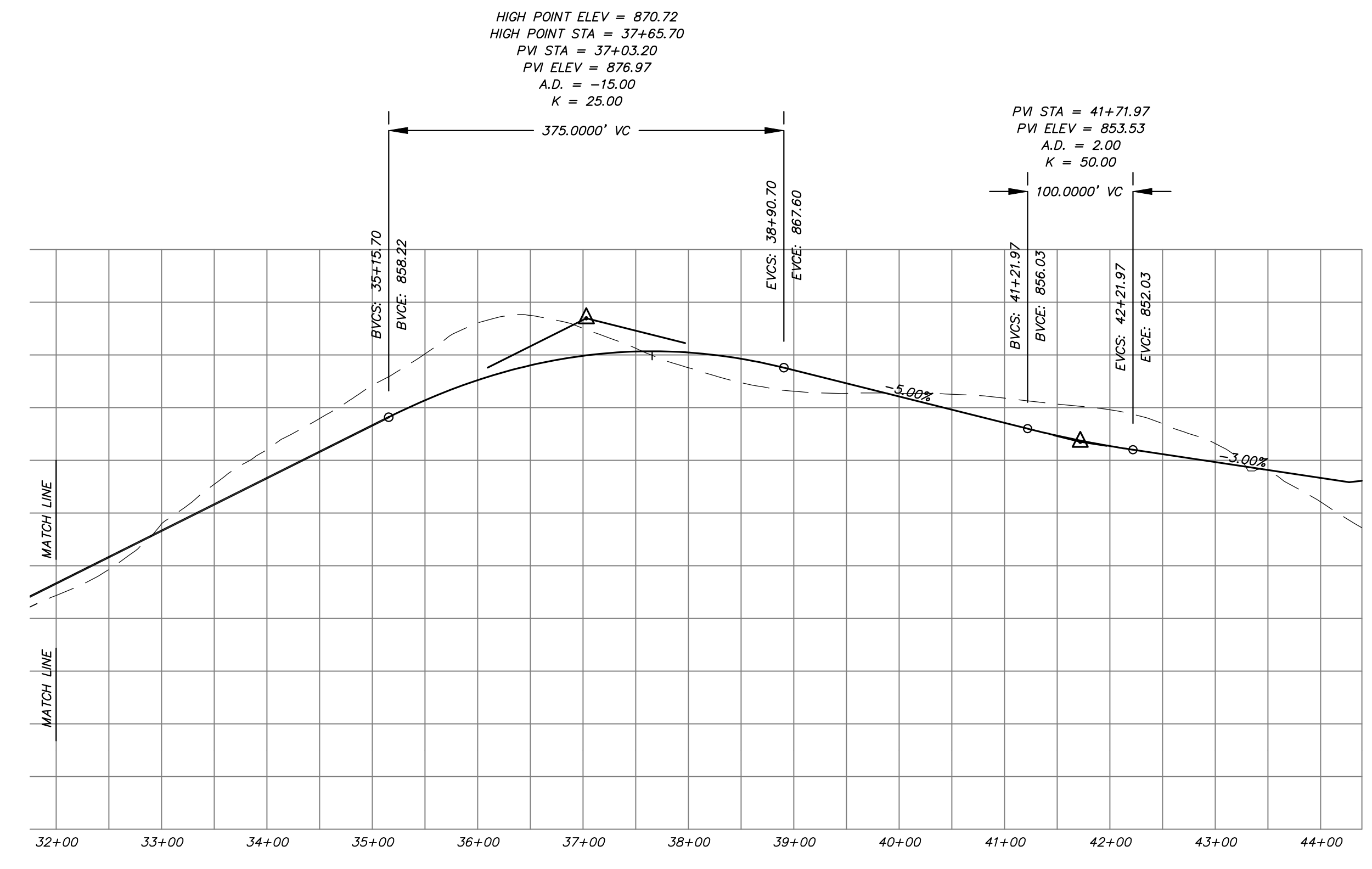

CONT. UNION HEIGHTS WEST ROAD
SCALE: HORIZ. 1" = 100'
VERT. 1" = 20'

NO.	DATE	REVISION	BY
PROJECT: UNION PLACE ROUTE 6 & BALDWIN PLACE ROAD, TOWN OF CARMEL, PUTNAM COUNTY, NEW YORK			
DRAWING: ROAD PROFILES			
PROJECT NO.	02119.100	PROJECT MANAGER	J.J.C.
DATE	06-18-10	DRAWN BY	S.J.C.
SCALE	AS SHOWN	CHECKED BY	R.D.W.
DRAWING NO.	PR-3	SHEET	25
			32

ALTERATION OF THIS DOCUMENT, UNLESS UNDER THE DIRECTION OF A LICENSED PROFESSIONAL ENGINEER, IS A VIOLATION OF SECTION 2209 OF ARTICLE 145 OF THE EDUCATION LAW.