

MATCHLINE TO SP-22
MATCHLINE TO SP-21

MATCHLINE TO SP-22
MATCHLINE TO SP-21

MATCHLINE TO SP-23
MATCHLINE TO SP-21

MAPLE DRIVE

SPRING DRIVE

BALDWIN PLACE ROAD

NORTH ENTRANCE ROAD (TOWN ROAD)

U.S. ROUTE 6

KENNARD ROAD

N.Y.S. ROUTE 118

LEGEND

	Existing Property Line
	Existing Wetland Limit Line w/ Wetland Flag
	Existing Wetland Buffer
	Existing Wetland Symbol
	Existing 150' NYSEG CORP. Easement
	Existing Vegetation
	Existing Tree Line
	Existing Stone Wall
	Proposed Curb
	Proposed Lighting
	Proposed Sign
	Proposed Landscaping
	Proposed Retaining Wall
	Proposed Permeable Pavement
	Proposed Permeable Pavers

SIGN TABLE

Key	Sign	M.U.T.C.D. Number	Size of Sign (s.f.)	Description
1		R7-8	12" x 18"	Blue on White
2		R1-1C	30" x 30"	White on Red
3		R5-1C	30" x 30"	White on Red
4		R7-1	12" x 18"	Red on White
5		R6-1	12" x 36"	Black Background White Arrow
5		R6-1	12" x 36"	Black Background Black Letters
6		W5-2B	36" x 36"	Black on Yellow
7		R1-2B	30"	White Background Red Symbol
8		R2-1C	24" x 30"	Black on White
9		R4-7C	24" x 30"	Black on White

General Notes:

- Screned topsoil shall be imported, when necessary, to complete the spreading of topsoil in accordance with Planting Note #6.
 - All landscaping shall be maintained, in a vigorous growing condition, by the applicant and/or its successors.
- Planting Notes:**
- All plant materials to be nursery grown.
 - Plants shall conform with the American Association of Nurserymen Standards in all ways including dimensions.
 - Plants shall be planted in all locations designated on the plan or as staked in the field by the project Landscape Architect.
 - All plants shall be hardy under climate conditions similar to those in the locality which they are to be planted.
 - 4" of Cedar Bark Mulch shall be spread over all planting beds areas.
 - All proposed seeded areas to receive 4" min. depth of topsoil; all proposed landscaped areas to receive 12" min. depth of topsoil.
 - Upon final grading and placement of topsoil and any required soil amendments, areas to receive permanent vegetation cover in combination with suitable mulch as follows:
 - Fertilizer applied at the rate of 14 lbs. per 1000 sf using 10-6-4 or equivalent.
 - Seed mixture: to be planted between April 1 and May 15, or between August 15 and October 15 or as directed by Project Representative (See Site and Stormwater Management Basin Seeding and Planting Notes for specific seed mixes)
 - Mulch: Salt Hay or Small Grain Straw applied at a rate of 90 lbs. per 1000 sf or 2 tons per acre, to be applied and anchored according to New York Standards & Specifications for Erosion & Sediment Control, Latest Edition.
 - If the season prevents the establishment of a permanent vegetation cover, the disturbed areas will be mulched with straw or equivalent.

ALTERATION OF THIS DOCUMENT, UNLESS UNDER THE DIRECTION OF A LICENSED PROFESSIONAL ENGINEER, IS A VIOLATION OF SECTION 2209 OF ARTICLE 145 OF THE EDUCATION LAW.

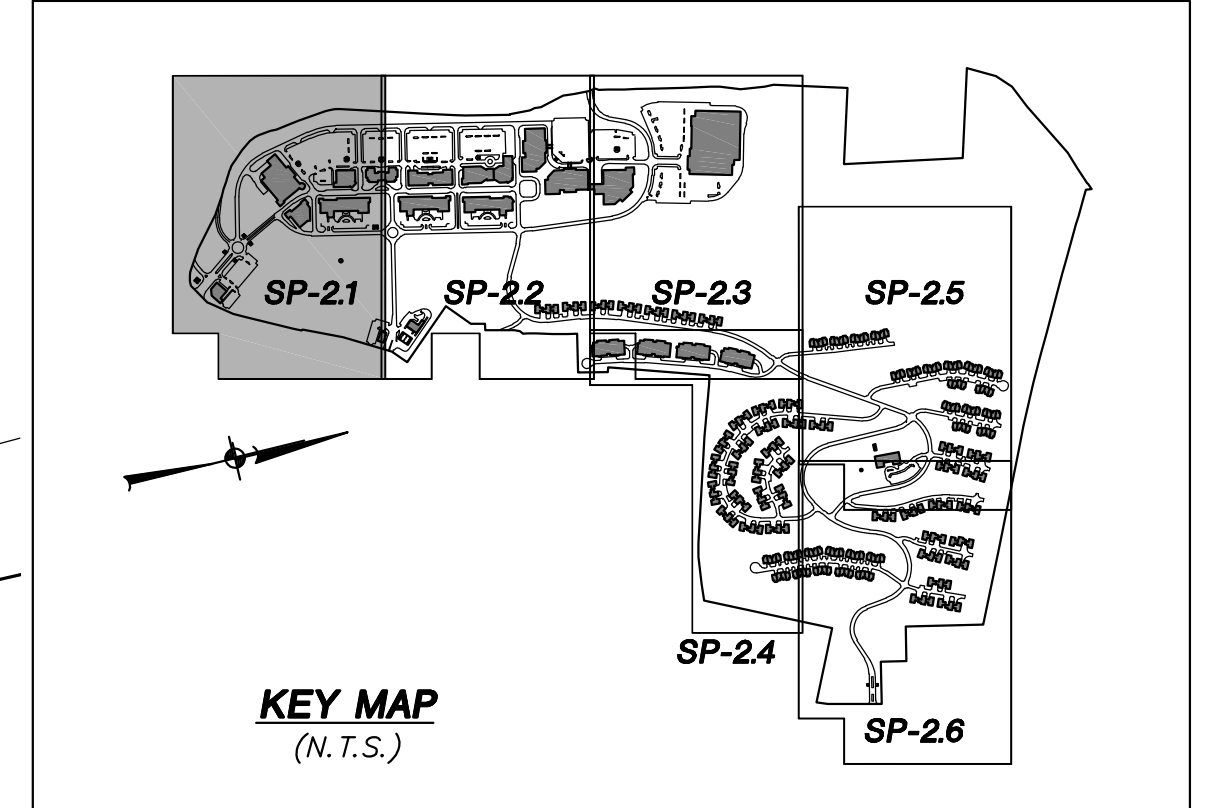
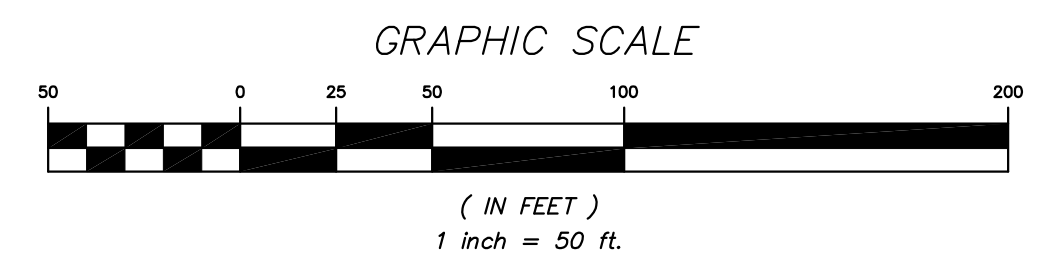
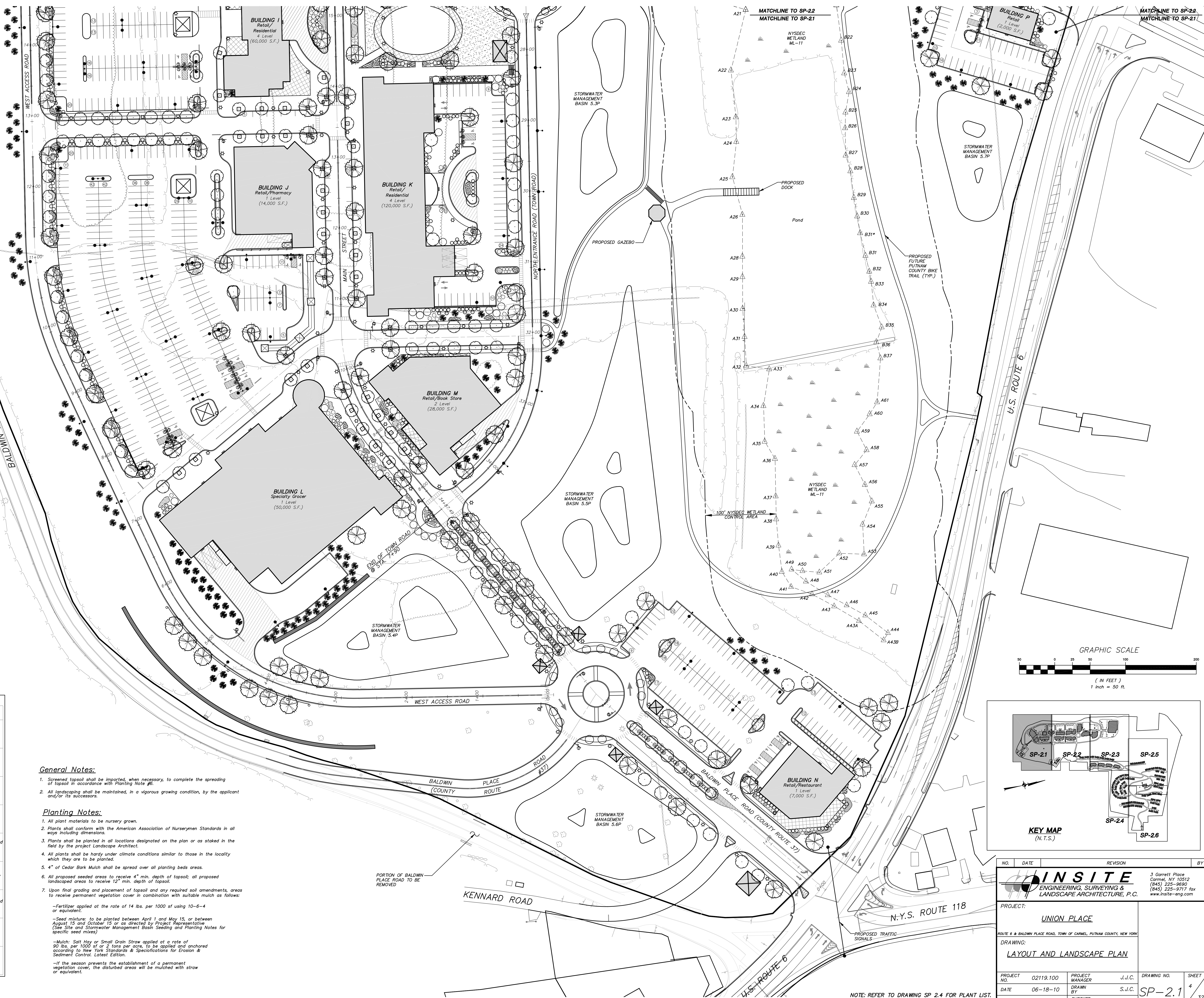

NO.	DATE	REVISION	BY
<p>INSITE ENGINEERING, SURVEYING & LANDSCAPE ARCHITECTURE, P.C.</p> <p>3 Garrett Place Carmel, NY 10512 (845) 225-9690 (845) 225-9717 fax www.insite-eng.com</p>			
PROJECT: UNION PLACE			
DRAWING: LAYOUT AND LANDSCAPE PLAN			
PROJECT NO.	02119.100	PROJECT MANAGER	J.J.C.
DATE	06-18-10	DRAWN BY	S.J.C.
SCALE	1" = 50'	CHECKED BY	R.D.W.
DRAWING NO.			SHEET
SP-2.1			4
			32

NOTE: REFER TO DRAWING SP 2.4 FOR PLANT LIST.