

MATCHLINE TO SP-32
MATCHLINE TO SP-31

MATCHLINE TO SP-32
MATCHLINE TO SP-31

MATCHLINE TO SP-32
MATCHLINE TO SP-31

MAPLE DRIVE

SPRING DRIVE

BALDWIN PLACE ROAD

U.S. ROUTE 6

KENNARD ROAD

N.Y.S. ROUTE 118

LEGEND	
	Existing Property Line
	Existing 10' Contour
	Existing 2' Contour
	Existing Spot Grade
	Proposed 10' Contour
	Proposed 2' Contour
	Proposed 1' Contour
	Proposed Spot Grade
	Existing Wetland Limit Line w/ Wetland Flag
	Existing Wetland Buffer
	Existing Wetland Symbol
	Existing 150' NYSEG CORP. Easement
	Existing Stone Wall
	Proposed Drainage Manhole
	Proposed Catch Basin
	Proposed Outlet Structure
	Proposed Drainage Pipe
	Proposed Proposed End Section w/ Rip Rap
	Proposed Roof Drain
	Proposed Grass Swale
	Proposed Sewer Main
	Proposed Sewer Foremain
	Proposed Sewer Manhole
	Proposed Sewer Service
	Proposed Sewer Cleanout
	Proposed Retaining Wall

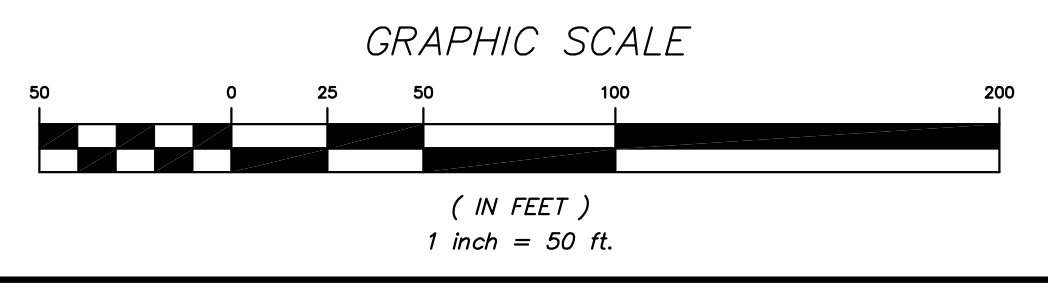

ALTERATION OF THIS DOCUMENT, UNLESS UNDER THE DIRECTION OF A LICENSED PROFESSIONAL ENGINEER, IS A VIOLATION OF SECTION 2209 OF ARTICLE 145 OF THE EDUCATION LAW.

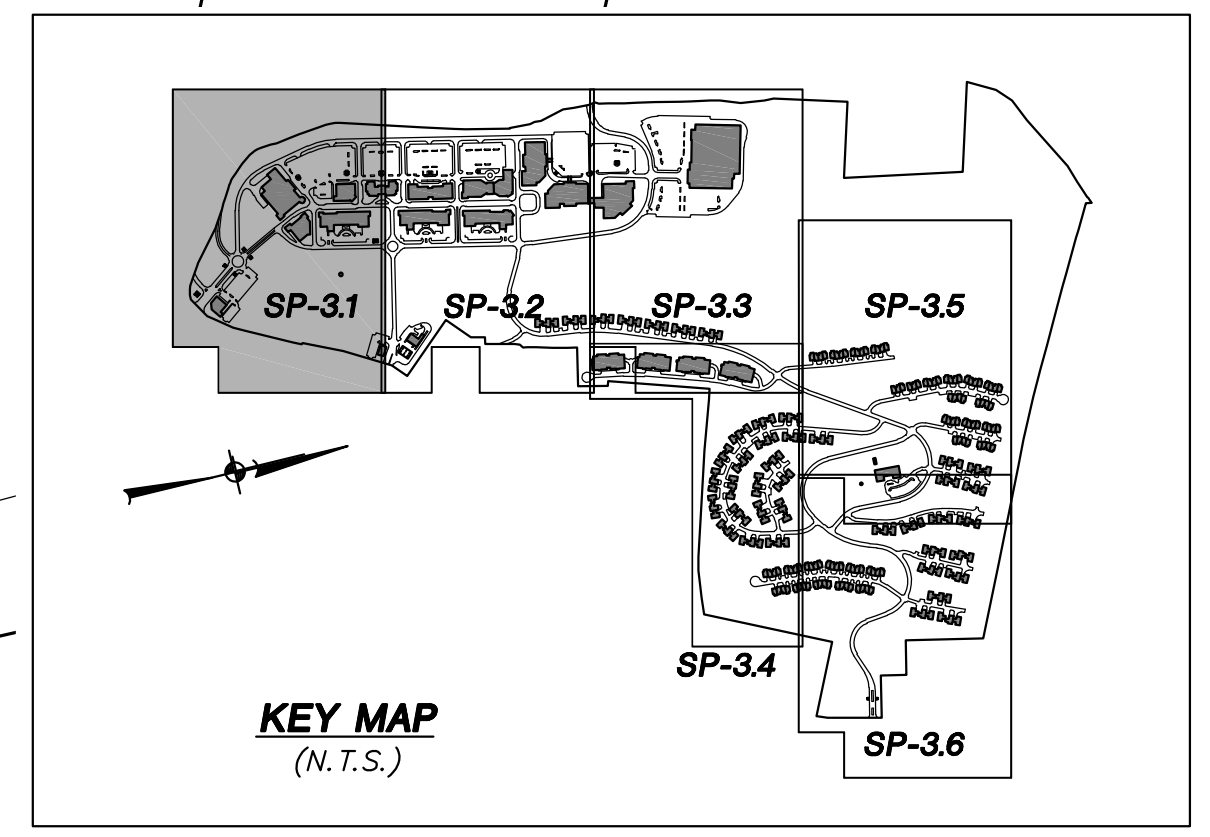

NO.	DATE	REVISION	BY
PROJECT: UNION PLACE <small>ROUTE 6 & BALDWIN PLACE ROAD, TOWN OF CARMEL, PUTNAM COUNTY, NEW YORK</small>			
DRAWING: GRADING AND UTILITIES PLAN			
PROJECT NO.	02119.100	PROJECT MANAGER	J.J.C.
DATE	06-18-10	DRAWN BY	J.L.K.
SCALE	1" = 50'	CHECKED BY	R.D.W.
DRAWING NO.	SP-3.1		SHEET
			10
			32

